

UNIVERSAL IMV KOMBICOLOR | ITM00747



Kombicolor is a durable stainless steel bovine semen applicator, which can be used with both mini and medium straws. The added ridge eliminates the need for O-rings and ensures a tight connection with unsplit sheaths. Five colors are available for easy differentiation.

AI Gun Kombicolor | ITM00747

Item Number	Colours available
ITM00747	<ul style="list-style-type: none"> ● RED ● BLUE ● YELLOW ● GREEN ○ WHITE

UNIVERSAL O-RING GUN (1/4 & 1/2) | ITM00742



The most versatile insemination gun on the market today. No need to change ends or use adapters, this convenient gun will seat both 1/2 ml and 1/4 ml straws with ease.

UNIVERSAL O-RING Gun (1/4 & 1/2) ITM00742

Item Number	Options available
ITM00742	

SS FRENCH MED SYRINGE D-101 (O-RING) 0.5cc | ITM00657



0.5cc Original Style. Slit sheath must be used with this gun. Made of durable stainless steel with welded components.

SS Syringe 0.5cc | ITM00657

Item Number	Size
ITM00657	0.5cc

A.I. LUBE | ITM00699



A lubricating jelly. For all types of non-sterile medical procedures:

- PRESERVED,
- ISOTONIC,
- pH BUFFERED,
- NON-SPERMICIDAL,
- NON-IRRITATING,
- WATER-SOLUBLE.

A.I. Lube | ITM00699

Item Number	Quantity
ITM00699	one gallon



South Africa

CONSUMABLES

CITO THAW & MONITOR, 12v DC/220v AC | ITM00712



Versatility and convenience in one unit.
The CITO Digital Thaw Unit is ideal for thawing frozen semen straws, as water will be kept at a steady temperature while plugged into either 12V DC or 220V AC.

A card-style thermometer and straw-lifting basket are included with the Cito Thaw Unit.

Cito Thaw and Monitor | ITM00712

Item Number

ITM00712

THAW MONITOR - Centigrade | ITM00713



An unbreakable THAW temperature indicator tested and used by major breeding organizations.

Its accuracy and reliability exceeds the presently used dial thermometer.

Thaw Monitor | ITM00713

Item Number

ITM00713

ESTROTECT - Breeding Indicator | ITM00258



ESTROTECT.
- Breeding Indicator.
Identify when cows are ready to breed.
Available in 5 colours.

- - Red
- - Pink
- - Green
- - Yellow
- - Blue

ESTROTECT | ITM00258

Item Number

Options available

- - Red
- - Pink
- - Green
- - Yellow
- - Blue

NON-DISPOSABLE B6-3280 O-RINGS | ITM00656



For use with cattle Insemination Guns.

Multiple colors available for easy identification.

Non-Disposable O-rings | ITM00656

Item Number All colours available

ITM00656

CITO CUTTER | ITM00659



The Cito Cutter is designed to quickly cut off the crimped end of the semen straw.

A push of the button cuts the straw off at the proper length.

Cito Cutter | ITM00659

Item Number

ITM00659

LN2 MEASURING STICK | ITM0419



Liquid Nitrogen Measuring Stick/Ruler (reads 1 - 50cm).

- Durable.
- Easy to use liquid nitrogen ruler.

LN2 Measuring Stick | ITM0419

Item Number

ITM0419

TWEEZERS PLASTIC | ITM00661



Tweezers designed with a specifically grooved tip that grips and surrounds the straw, yet does not crush it during removal of the straw from the liquid nitrogen storage.

Protects your hands during semen handling as plastic transmits very little heat or cold.

Tweezers plastic | ITM00661

Item Number

ITM00661

MILKER'S GLOVES - 4 sizes | ITM00746



Blue nitrile milker's gloves. Powder free and latex free. Non sterile. For single use.

- 4 Sizes available
- Small
 - Medium
 - Large
 - X-large

Sold in a box of x100 gloves.

Milker's Gloves | ITM00746

Item Number	Sizes available
ITM00746	Small
	Medium
	Large
	X-large

x100 gloves/box

POLYSEM A.I. GLOVES | ITM00652



100% polyethylene smooth, extremely strong gloves, with ultra high sensitivity. Shoulder-length gloves. For rectal exams, artificial insemination and obstetrics.

100 gloves per box.

A.I. Gloves | ITM00652

Item Number	Quantity/box
ITM00652	x100 gloves/box

21" INFUSION TUBE B8-5230 (25/pack) | ITM00695



PVC tubes designed for use with many of the common uterine solutions on the market.

- with smooth, round polished ends.

21" Infusion Tube | ITM00695

Item Number
ITM00695
Qty: 25/pack

SHEATHS ALPHA IMV | ITM00725



Its two lateral exit holes allow consistent deposit of semen and improve hygiene during insemination by avoiding backflow. Its transparent head makes fluids easy to see upon withdrawal and allows easy reading and scanning of the barcode.

Sheaths Alpha | ITM00725

Item Number
ITM00725



South Africa

CONSUMABLES

IND WRAP SPLIT SHEATH D-302 GRN ADAPTOR | ITM00731



Sheaths are available individually wrapped in a soft plastic sleeve which can be used as a double walled insemination device to minimize intrauterine contamination.

Sheaths | ITM00731

Item Number	Options available
ITM00731	

SPLIT SHEATH - GREEN ADAPTOR (50/pack) | ITM00727



Split Sheath. PVC sheath designed with an insert provides a secure seat for the straw and can be used for both 1/2 ml and 1/4 ml straws.

Sheaths | ITM00727

Item Number	Options available
ITM00727	Green Adapter - split
	x50 /pack

UNSPLIT SHEATH - BLUE ADAPTOR (50/pack) | ITM00726



Unsplit Sheath. PVC sheath designed with an insert provides a secure seat for the straw and can be used for both 1/2 ml and 1/4 ml straws.

Sheaths | ITM00726

Item Number	Options available
ITM00726	Blue Adapter - unsplit
	x50 /pack

DISPOSABLE SHEATH PROTECT (80/roll) | ITM00735



The sanitary sleeve is a fine plastic sleeve that fits over the gun when it is ready for ET. The gun is inserted with the sanitary sleeve in place covering the gun. It prevents any contamination from the outside of the animal being picked up by the gun and getting carried into the uterus, which may reduce conception.

Disp. Sheath Protect | ITM00735

Item Number
ITM00735
Qty: 80/roll

VALIANT NON RETURN TEAT CUP (GREEN) | ITM02630



Non Return Dip Cup (Green) a non-return valve inside the cup prevents the already used teat dip from siphoning back down into the reservoir, making it hygienic, practical and safe for use.
It features an angled cup with handle on the top connected to a plastic bottle at the bottom. The splash proof bottle holds approximately 300ml of solution.
The Dip Cup is chemical resistant and durable.

**Non Return Teat Cup
ITM02630**

Item Number

ITM02630

VALIANT MANUAL FOAMING CUP (BLUE) | ITM02537



This manual foaming teat dip cup uses a special foaming insert which sits in the dip cup reservoir. It generates foam as the dip cup is squeezed and raises to fill the dip cup chamber with foam.
Easy squeeze action for rapid and consistent foam generation.
Can be dismantled for cleaning.
Foaming technique is used to save liquid usage, but ensure optimal coverage of each teat.
It features an angled cup with handle on the top connected to a plastic bottle at the bottom.

**Foaming Cup
ITM02537**

Item Number

ITM02537

VALIANT SHALLOW WELL DIP CUP AMBIC (GREEN or BLUE) | ITM00709



An alternative version of the popular Original Return Dip Cup™, the MiniDipper™ has a 15ml dip cup capacity to suit small teated animals.
Non-return design prevents contaminated chemical returning to the dip cup bottle.
Clean, full strength chemical for each cows teats.
Specially designed splay-proof lip & overflow chamber to reduce spillage & overflow.
Soft squeeze bottle for ease of use. 15ml dip cup capacity
Blue or green in colour.

**Shallow Well Dip Cup
ITM00709**

Item Number

ITM00709

VALIANT REPLACE DIP CUP BOTTLE (spare) | ITM01290



Spare Valiant Dip Cup Bottle.
Bottle only.

Bottle (spare) | ITM01290

Item Number

ITM01290

MVE TANK XC20S | ITM00675



- PRECISION ENGINEERED TANK
- specifically for farm use.
 - TAMPER-PROOF hinged lid.
 - LOCKING TAB.
 - COLOUR CODED canister.
 - Neck tube REDUCES liquid nitrogen loss.
 - INSULATED for maximum thermal performance.
 - STRONG, LIGHTWEIGHT construction.
 - EASY RETRIEVAL of canisters.

MVE Tank | ITM00675

Item Number
ITM00675

CANISTER for MVE TANK XC20S | ITM00459

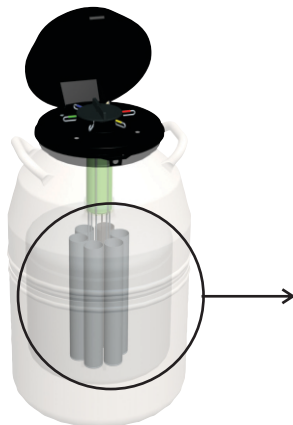

CANISTERS - for XC20S tank

Canister for MVE Tank | ITM00459

Item Number	Quantity
ITM00675	per canister